

MEC DIESEL



COMPONENTI INTERNI TESTA CILINDRI APPLICAZIONI FIAT • IVECO • MERCEDES

*VALVE TRAIN COMPONENTS
FIAT • IVECO • MERCEDES APPLICATIONS*

1.3 MJTD PANDA/500/PUNTO/Y

Componenti interni testa cilindri • Valve train components

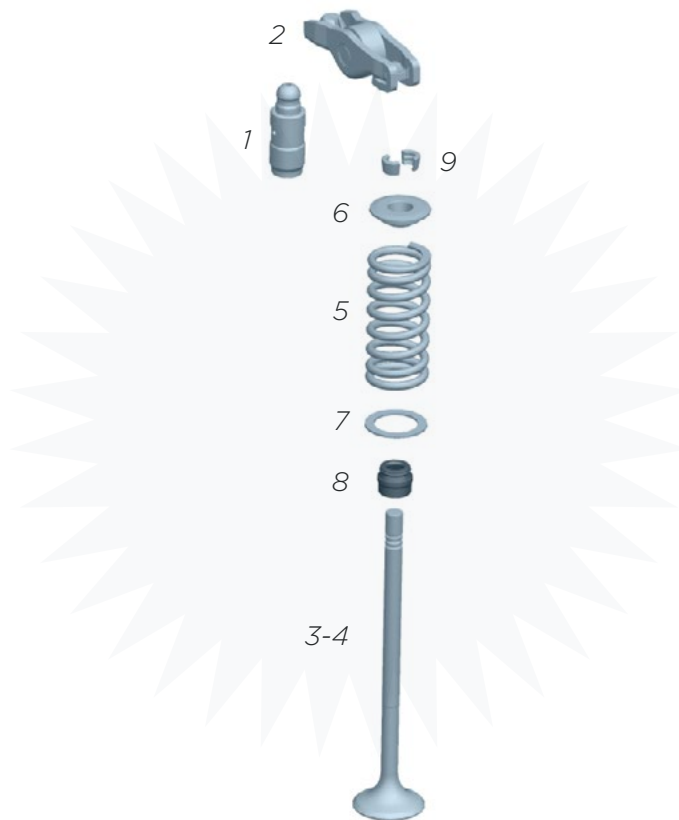

SUITABLE FOR - ADATTO A
1.3 MJTD PANDA/500/PUNTO/Y

	MEC REF	OE REF	DESCRIZIONE - Description	QTY	
1	220080	46475925	Punteria - tappets	16	
2	170150	73501138	Leva a bilanciere - rocker	16	
3	826970	55270167	Valvola di aspirazione - intake valve	8	
4	826980	55270169	Valvola di scarico - exhaust valve	8	
5	760120	55262539	Molla d. valvola - valve spring	16	
6	580215	46514612	Piattello reggimolla - spring plate	superiore - upper	16
7	580210	46817524	Piattello reggimolla - spring plate	inferiore - lower	16
8	521194	70-31306-00	Anello tenuta - sealing ring	16	
9	132420	14194670	Cuneo arresto valvola - valve wheel-wedge	32	

OM651 SPRINTER/VITO/VIANO

Componenti interni testa cilindri • Valve train components

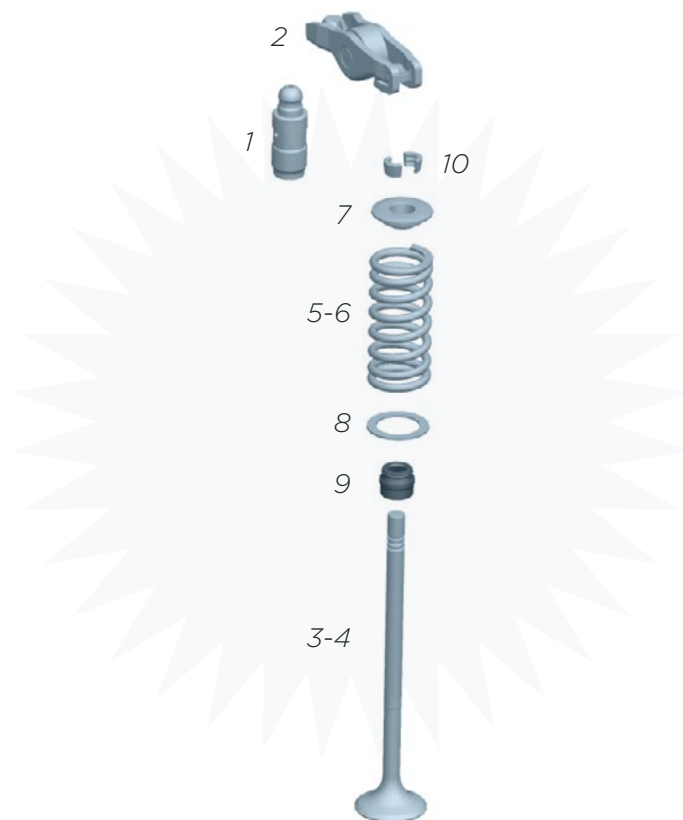

SUITABLE FOR - ADATTO A
OM651 SPRINTER/VITO/VIANO

	MEC REF	OE REF	DESCRIZIONE - Description	QTY	
1	221860M	A6510500080	Punteria - tappets	16	
2	170730M	A6510500033	Leva a bilanciere - rocker	16	
3	827280	A6510530101	Valvola di aspirazione - intake valve	8	
4	827285	A6510500127	Valvola di scarico - exhaust valve	8	
5	760070	A6510530020	Molla d. valvola - valve spring	aspirazione - intake	8
6	760080	A6400530120	Molla d. valvola - valve spring	scarico - exhaust	8
7	580130	A6680530025	Piattello reggimolla - spring plate	superiore - upper	16
8	580140	A6680530125	Piattello reggimolla - spring plate	inferiore - lower	16
9	521194	70-31306-00	Anello tenuta - sealing ring		16
10	580120	A0000531126	Cuneo arresto valvola - valve wheel wedge		32

F1AE0481/F1AE3481/F1AFL411 DAILY/DUCATO

Componenti interni testa cilindri • Valve train components

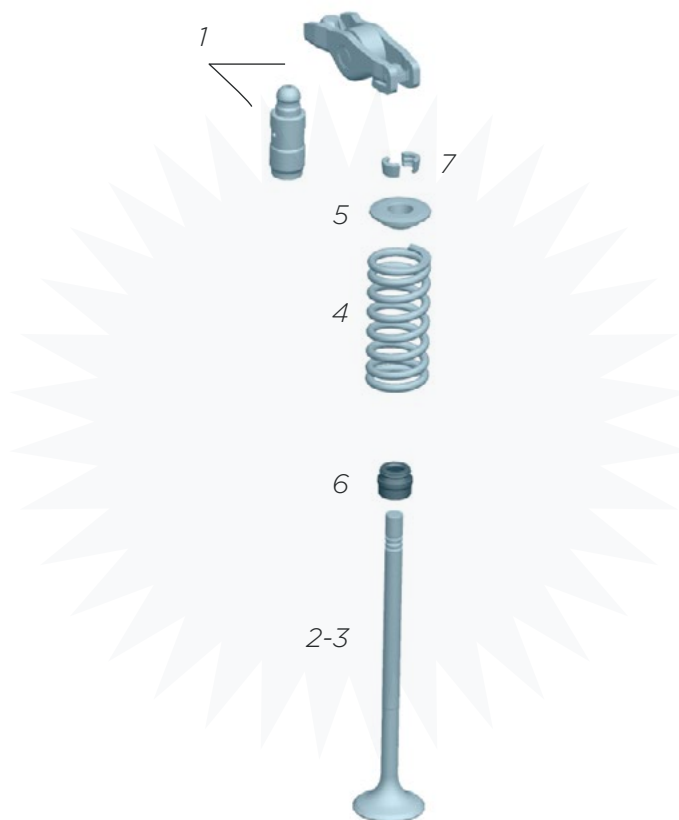

SUITABLE FOR - ADATTO A
F1AE0481/F1AE3481/F1AFL411 DAILY/DUCATO

	MEC REF	OE REF	DESCRIZIONE - Description	QTY
1	220350	5802723240	Punteria - tappets	16
2	827020	504069199	Valvola di aspirazione - intake valve	8
3	827230	504378070	Valvola di scarico - exhaust valve	8
4	760040	500348686	Molla d. valvola - valve spring	16
5	580070	500348685	Piattello reggimolla - spring plate	16
6	510920	70-37553-00	Anello tenuta - sealing ring	16
7	132420	14194670	Cuneo arresto valvola - valve wheel wedge	32

F1CE0481/F1CE3481/F1CFL411/F1CGL411 DAILY/DUCATO

Componenti interni testa cilindri • Valve train components

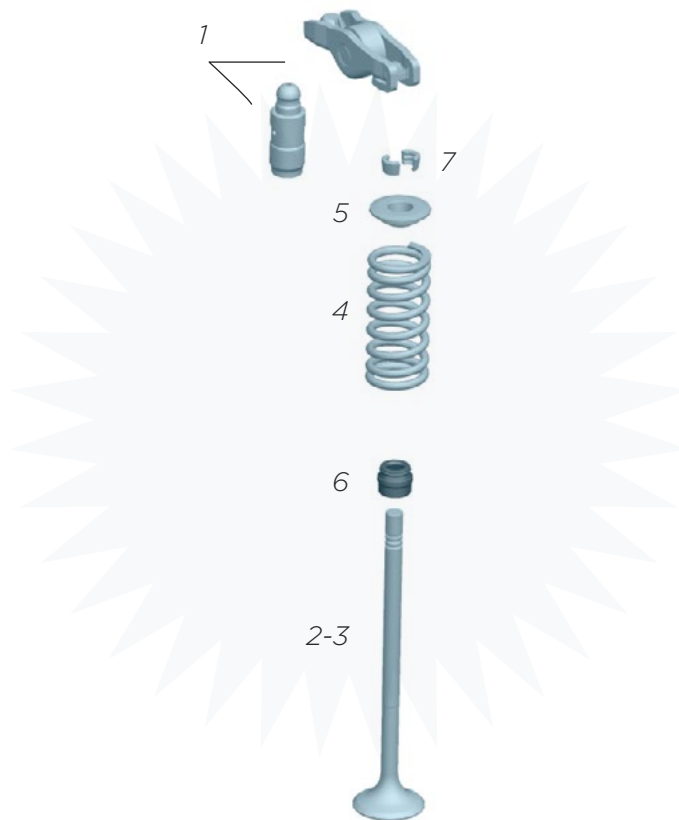

SUITABLE FOR - ADATTO A
F1CE0481/F1CE3481/F1CFL411/F1CGL411 DAILY/DUCATO

	MEC REF	OE REF	DESCRIZIONE - Description	QTY
1	220350	5802723240	Punteria - tappets	16
2	827100	504072531	Valvola di aspirazione - intake valve	8
3	827110	504081062	Valvola di scarico - exhaust valve	8
4	760040	500348686	Molla d. valvola - valve spring	16
5	580070	500348685	Piattello reggimolla - spring plate	16
6	510920	70-37553-00	Anello tenuta - sealing ring	16
7	132420	14194670	Cuneo arresto valvola - valve wheel wedge	32

F1CE0441/F1CFA401 CNG DAILY/DUCATO

Componenti interni testa cilindri • Valve train components

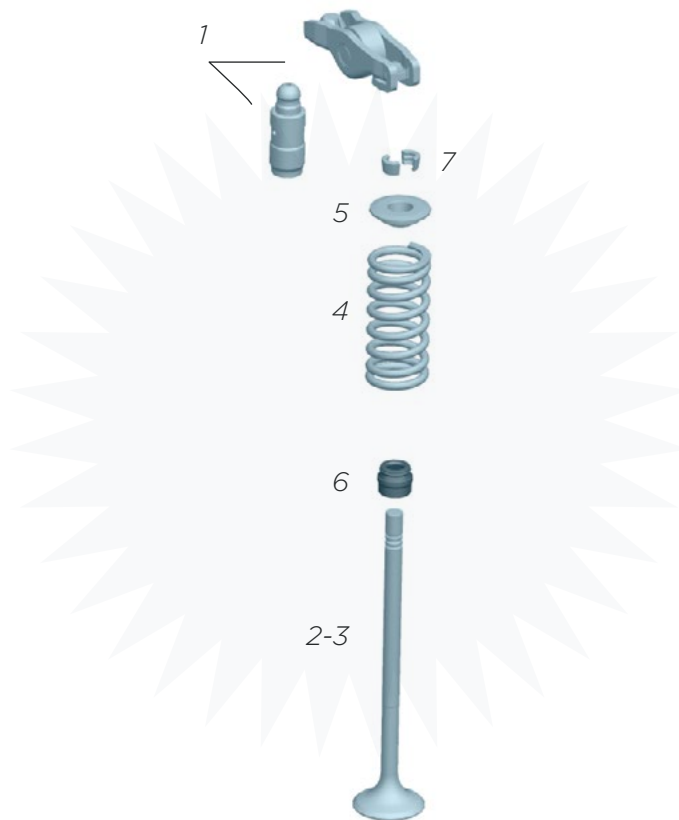

SUITABLE FOR - ADATTO A
F1CE0441/F1CFA401 CNG DAILY/DUCATO

	MEC REF	OE REF	DESCRIZIONE - Description	QTY
1	220350	5802723240	Punteria - tappets	16
2	827100	504072531	Valvola di aspirazione - intake valve	8
3	826960	5801687581	Valvola di scarico - exhaust valve	8
4	760040	500348686	Molla d. valvola - valve spring	16
5	580070	500348685	Piattello reggimolla - spring plate	16
6	510920	70-37553-00	Anello tenuta - sealing ring	16
7	132420	14194670	Cuneo arresto valvola - valve wheel wedge	32

F4AE0481/F4AE3481 TECTOR 4 CILINDRI

Componenti interni testa cilindri • Valve train components

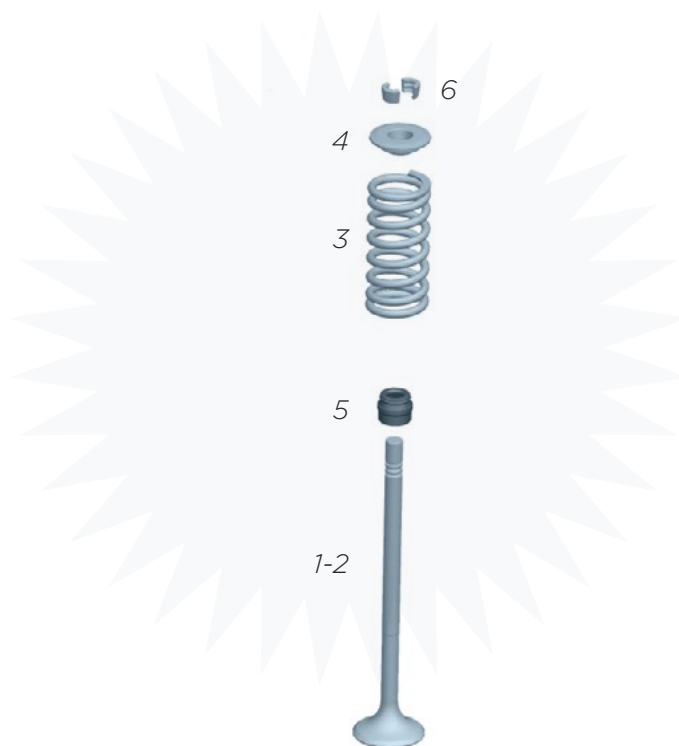

SUITABLE FOR - ADATTO A
F4AE0481/F4AE3481 TECTOR 4 CILINDRI

	MEC REF	OE REF	DESCRIZIONE - Description	QTY
1	822200	4895052	Valvola di aspirazione - intake valve	8
2	822210	4895051	Valvola di scarico - exhaust valve	8
3	760400	2831473	Molla d. valvola - valve spring	16
4	911590	4895074	Piattello reggimolla - spring plate	16
5	521190	70-40336-00	Anello tenuta - sealing ring	16
6	130390	4899081	Cuneo arresto valvola - valve wheel wedge	32

F4AE0681/F4AE3681 TECTOR 6 CILINDRI

Componenti interni testa cilindri • Valve train components

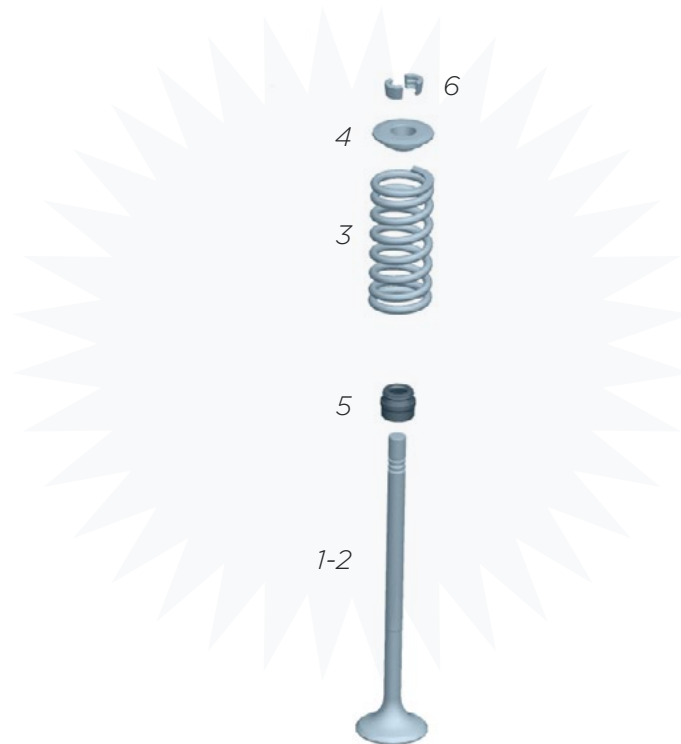

SUITABLE FOR - ADATTO A
F4AE0681/F4AE3681 TECTOR 6 CILINDRI

	MEC REF	OE REF	DESCRIZIONE - Description	QTY
1	822200	4895052	Valvola di aspirazione - intake valve	12
2	822210	4895051	Valvola di scarico - exhaust valve	12
3	760400	2831473	Molla d. valvola - valve spring	24
4	911590	4895074	Piattello reggimolla - spring plate	24
5	521190	70-40336-00	Anello tenuta - sealing ring	24
6	130390	4899081	Cuneo arresto valvola - valve wheel wedge	48

F2BE0681/F2BE3681 CURSOR 8

Componenti interni testa cilindri • Valve train components

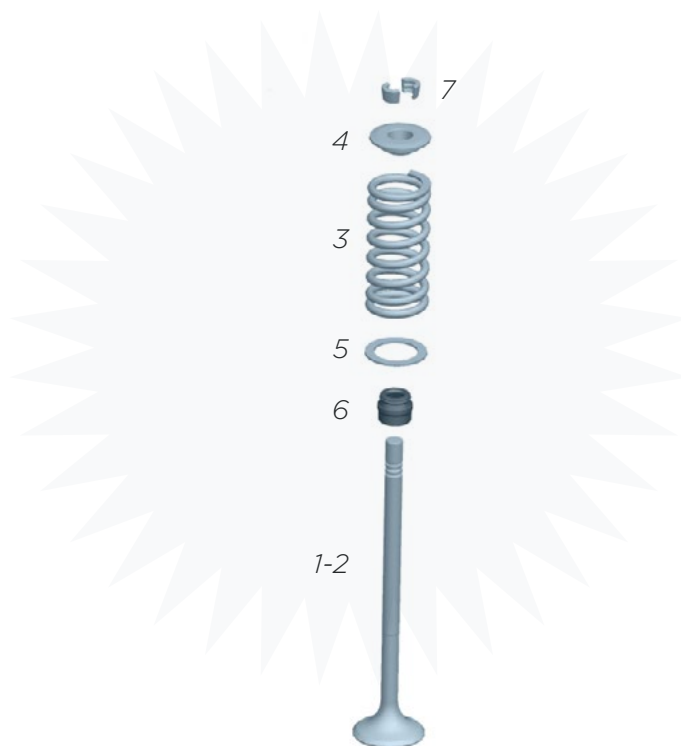

SUITABLE FOR - ADATTO A
F2BE0681/F2BE3681 CURSOR 8

	MEC REF	OE REF	DESCRIZIONE - Description	QTY
1	822220	500354685	Valvola di aspirazione - intake valve	12
2	822230	504078215	Valvola di scarico - exhaust valve	12
3	760530	504099998	Molla d. valvola - valve spring	24
4	132630	98471361	Piattello reggimolla - spring plate superiore - upper	24
5	132640	504107800	Piattello reggimolla - spring plate inferiore - lower	24
6	240720	49472020	Anello tenuta - sealing ring	24
7	132650	98499819	Cuneo arresto valvola - valve wheel wedge	48

F3AE0681/F3AE3681 CURSOR 10

Componenti interni testa cilindri • Valve train components

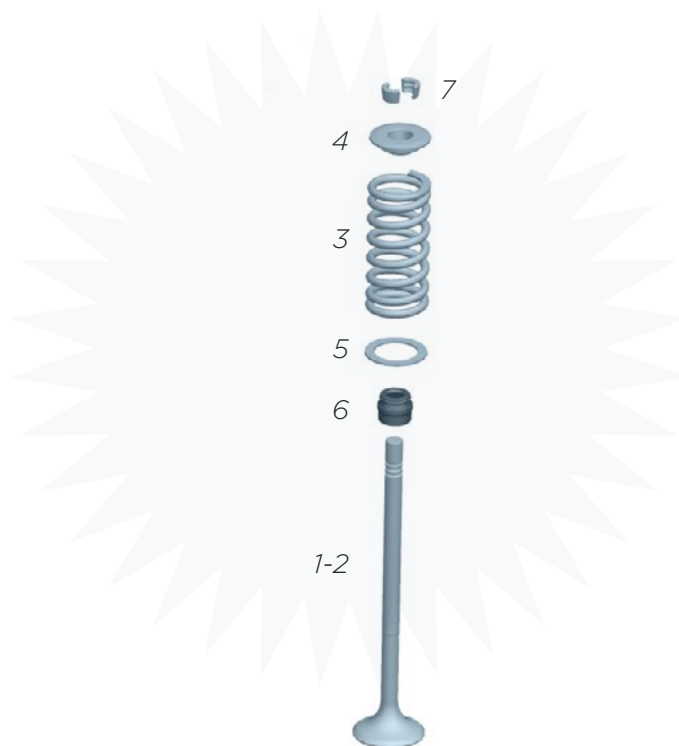

SUITABLE FOR - ADATTO A
F3AE0681/F3AE3681 CURSOR 10

	MEC REF	OE REF	DESCRIZIONE - Description	QTY
1	822240	500355776	Valvola di aspirazione - intake valve	12
2	822250	5801551454	Valvola di scarico - exhaust valve	12
3	760540	504099999	Molla d. valvola - valve spring	24
4	139200	99430785	Piattello reggimolla - spring plate superiore - upper	24
5	131340	504000042	Piattello reggimolla - spring plate inferiore - lower	24
6	520011	70-40217-00	Anello tenuta - sealing ring	24
7	962080	61320851	Cuneo arresto valvola - valve wheel wedge	48

F3BE0681/F3BE3681 CURSOR 13

Componenti interni testa cilindri • Valve train components

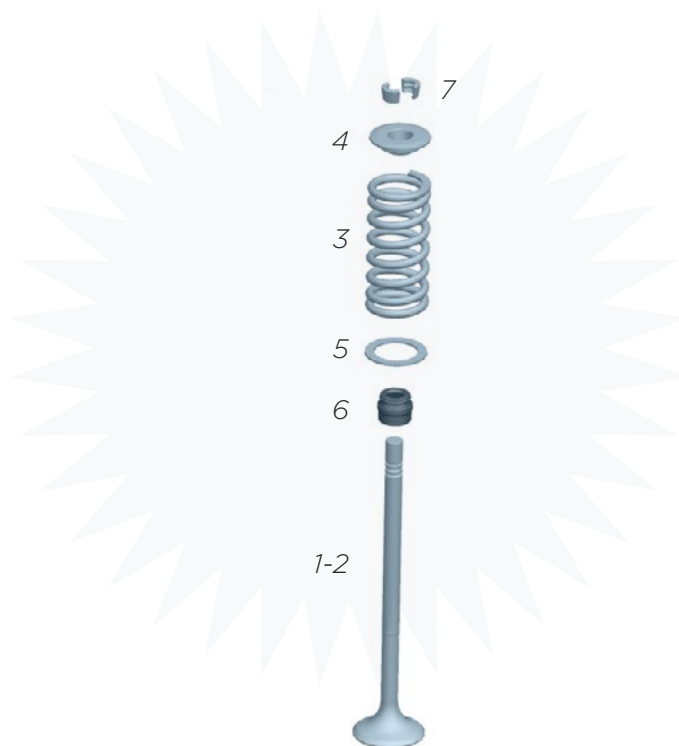

SUITABLE FOR - ADATTO A
F3BE0681/F3BE3681 CURSOR 13

	MEC REF	OE REF	DESCRIZIONE - Description	QTY
1	827000	500355778	Valvola di aspirazione - intake valve	12
2	827010	504293892	Valvola di scarico - exhaust valve	12
3	760390	504100000	Molla d. valvola - valve spring	24
4	139210	98473050	Piattello reggimolla - spring plate	superiore - upper 24
5	130570	504107641	Piattello reggimolla - spring plate	inferiore - upper 24
6	520330	70-40218-00	Anello tenuta - sealing ring	24
7	130500	14196370	Cuneo arresto valvola - valve wheel wedge	48